



# Technical Bulletin

## E-Series Carton Clamp Arm Replacement

This bulletin describes the replacement of arms for E-Series Carton Clamps.

The following procedures can be performed with the attachment mounted on the truck.

- 1 Extend the arms to frame width. Lower the contact pads so that they are approximately 18 in. (45 cm) above the floor.
- 2 Install eyebolts or a clamp and overhead hoist to the top center of the contact pad. Take up slack in the chain.
- 3 Remove the stabilizer and contact pad assembly from the arm by removing the two pin retainers and pivot pins. For reassembly, tighten the retainer capscrews to 15 ft.-lbs. (20 Nm).
- 4 Inspect the stabilizer pivot pin and bushings for wear and replace as necessary.

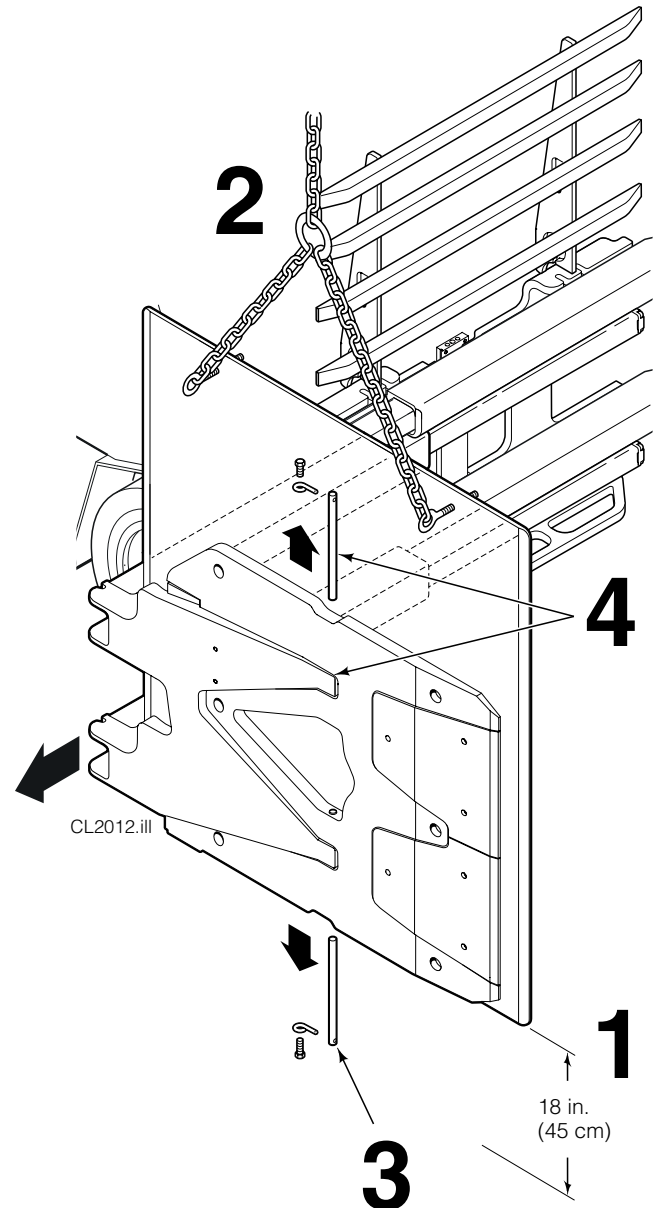

**NOTE:** This information should not be interpreted as the basis for warranty claims unless so designated.

**cascade**<sup>®</sup>  
**corporation**

**For Technical Support . . .**

Call: 1-800-227-2233

**OR**

Write: Cascade Corporation, P.O. Box 20187, Portland, OR 97294

**To Order Parts . . .**

Call: 1-888-227-2233

**OR**

Write: Cascade Corporation, 2501 Sheridan Ave., Springfield, OH 45505

- 5 Lower the attachment to the floor.
- 6 Remove the upper and lower cylinder rod anchor bars on the arm to be removed. Slowly power the cylinder rods open to expose the rod ends. For reassembly, apply Loctite 242 (Blue) and tighten the anchor bar capscrews to a torque value of 50 ft.-lbs. (65 Nm).
- 7 Slide the rod end toward the cylinder to remove the split-ring keepers. Slide the rod end off the cylinder rod. Inspect rod end and keepers for wear.
- 8 Retract the cylinder rods.
- 9 Remove the spring plate from the inside surface of the arm. For reassembly, tighten the spring capscrews to a torque of 30 ft.-lbs. (40 Nm).

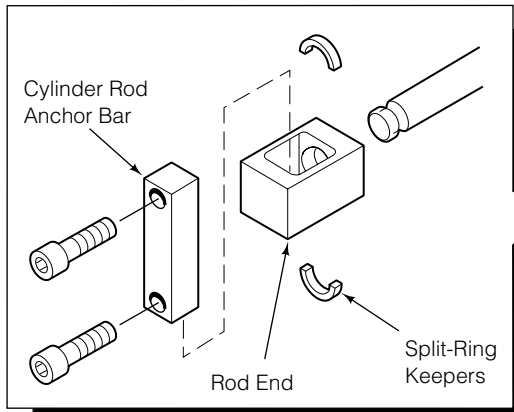

CL0374.iii

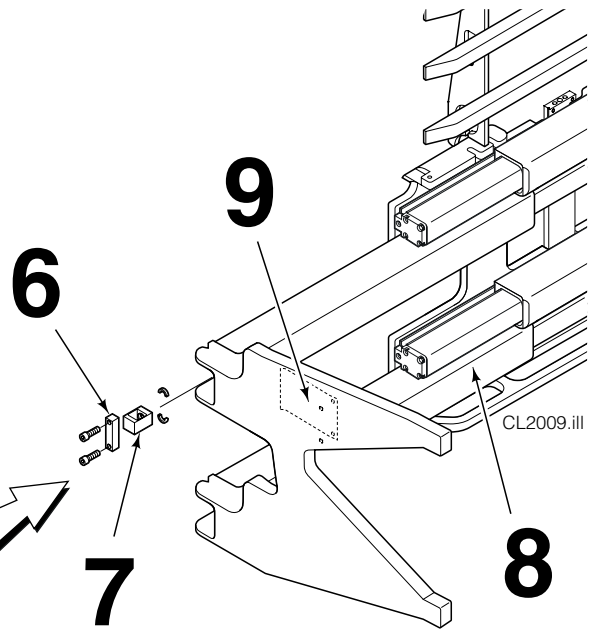

**WARNING:** Make sure the hoist used to remove the arm has a rated capacity of at least 1000 lbs. (450 kg.)

- 10 Attach an overhead hoist and chain to the arm. Position the chain clear of the arm bearing surfaces.
- 11 Slide the arm out of the frame. Do not damage the bearings when removing the arm.
- 12 For reassembly, reverse the above procedures with the following exceptions:
  - Inspect the upper and lower arm bearings for wear. Bearing thickness should not be less than 1/8 in. (3 mm) as measured on the bottom or sides. Install new bearings as required.
  - Inspect the arm bar bearing contact and chamfered areas for nicks or damage. Break any sharp edges and polish with 400-grit emery paper as necessary.
  - Apply silicone spray or light grease to the bearing contact areas.

