



Installation Instructions

Mark 55 Radio Frequency (RF) Hydraulic Control Kit 6086562, 6090114, 6095181, 6095182 and Conversion Kit 6095183

This sheet provides installation instructions and replacement parts list for Cascade Hydraulic Control Kits 6086562, 6090114, 6095181, 6095182 and Cascade Conversion Kit 6095183. The kits provide two function operation using a single function hydraulic supply and radio frequency (RF) solenoid actuation to select the push/pull or platen position functions. The attachment mounted solenoid is battery powered and driver activated by a remote transmitter mounted on the truck.

CAUTION: If the truck or attachment will be cleaned with a pressure washer, remove the battery and receiver from the attachment prior to cleaning. High pressure water can damage the battery and receiver.

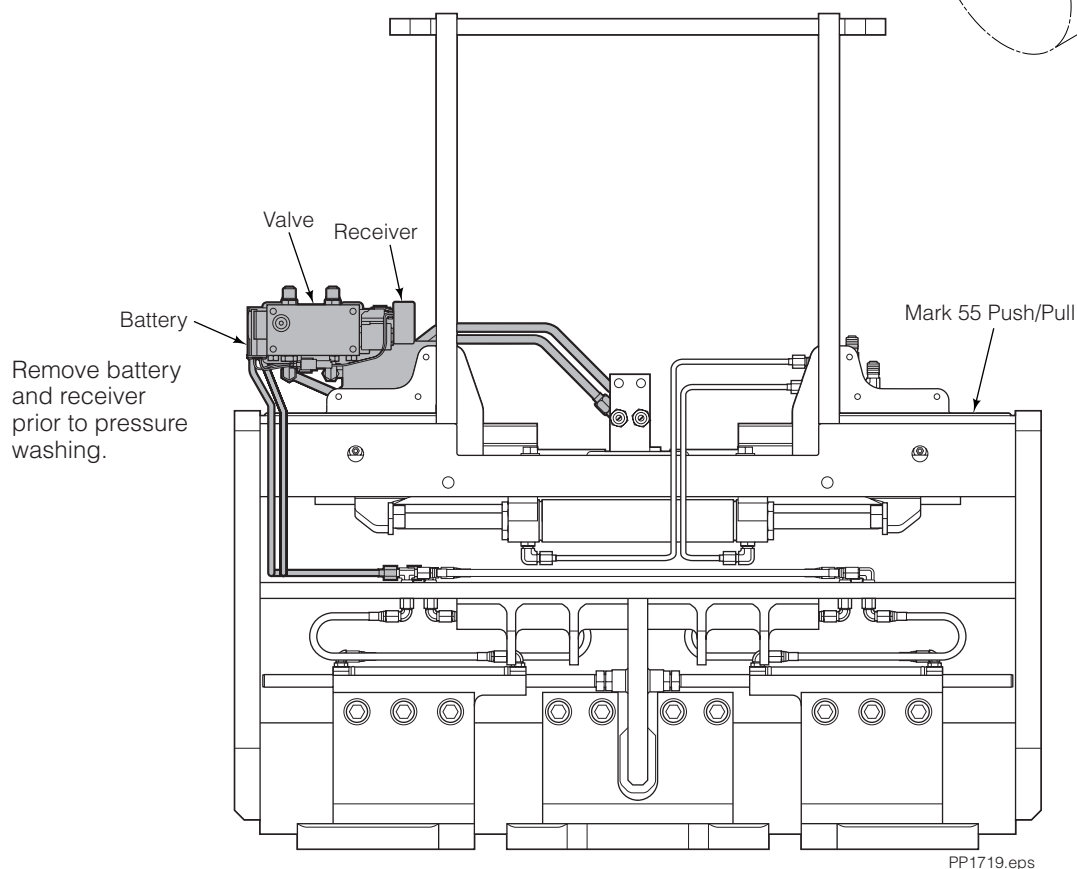
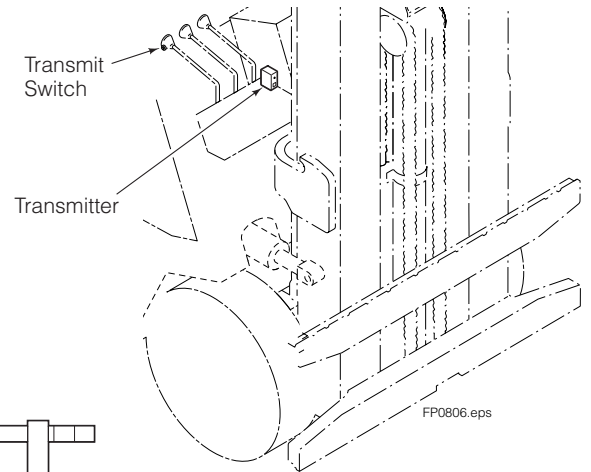

cascade[®]
corporation

For Technical Support . . .

Call: 1-800-227-2233 Fax: 1-888-329-8207
Internet: www.cascorp.com
Write: Cascade Corporation, PO Box 20187, Portland, OR 97294

To Order Parts . . .

Call: 1-888-227-2233 Fax: 1-888-329-0234
Internet: www.cascorp.com
Write: Cascade Corporation, 2501 Sheridan Ave., Springfield, OH 45505

Conversion Kit 6095183 Installation

The following instructions describe how to install the Radio Frequency Hydraulic Control kit. The kit includes new valve, tubes, brackets, receiver, transmitter, battery, and battery charger.



WARNING: Before removing any hoses, relieve pressure in the hydraulic system. With the truck off, open the truck auxiliary control valve(s) several times in both directions.

- 1 Remove existing solenoid valve(s), tubes, cables and brackets. If equipped, remove battery and receiver.
- 2 Mount bracket to attachment and tighten capscrews to 13-15 ft.-lbs. (18-20 Nm).

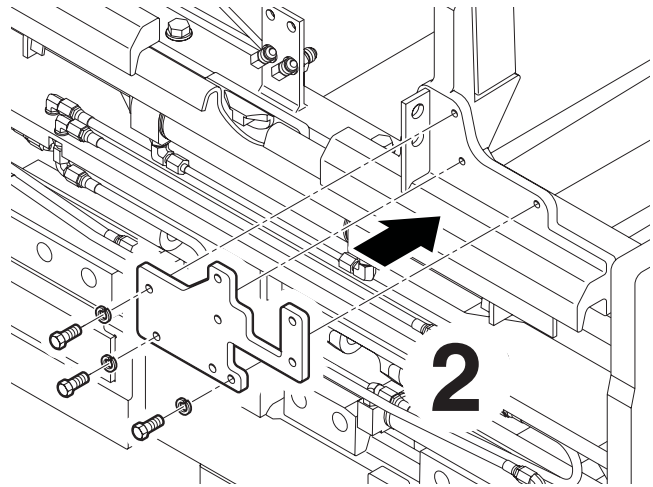

PP1602.eps

- 3 Install fittings to the valve.

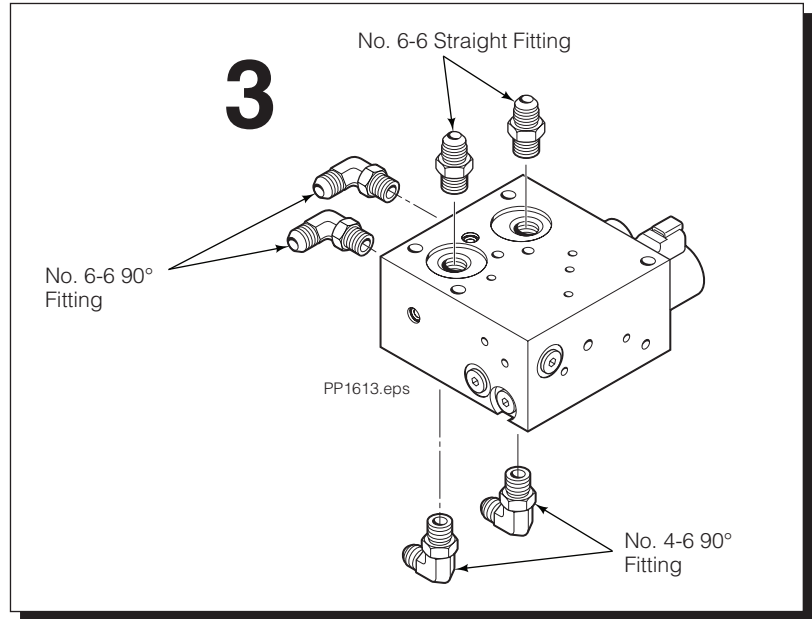

- 4 Mount valve to bracket and tighten capscrews to 13-15 ft.-lbs. (18-20 Nm).

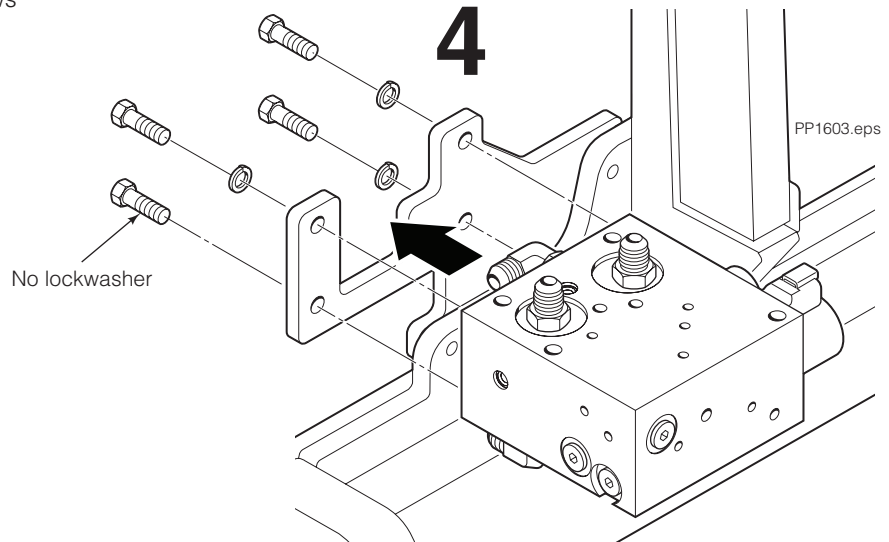

5 Mount battery clip and receiver clip to valve.

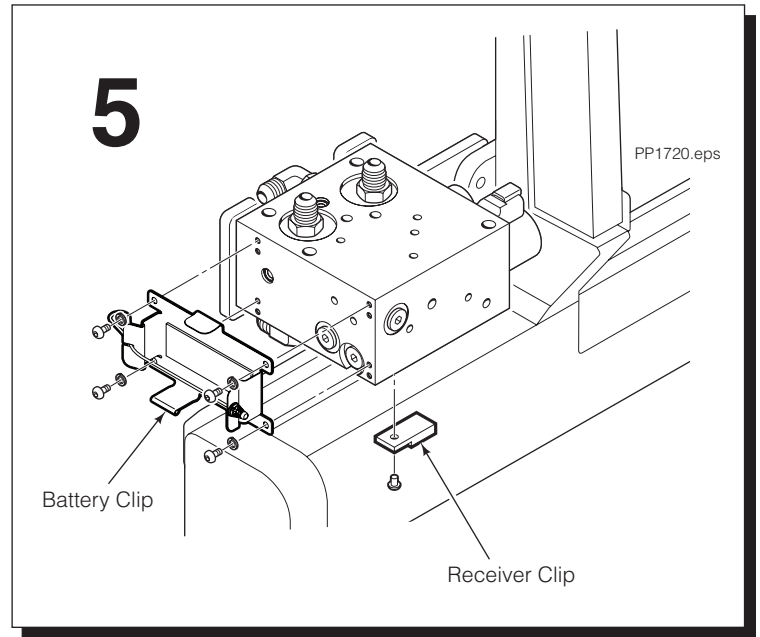

6 Pull latch on battery clip. Install battery into battery clip and secure latch.

7 Install receiver to valve solenoid. Connect receiver plug with battery plug.

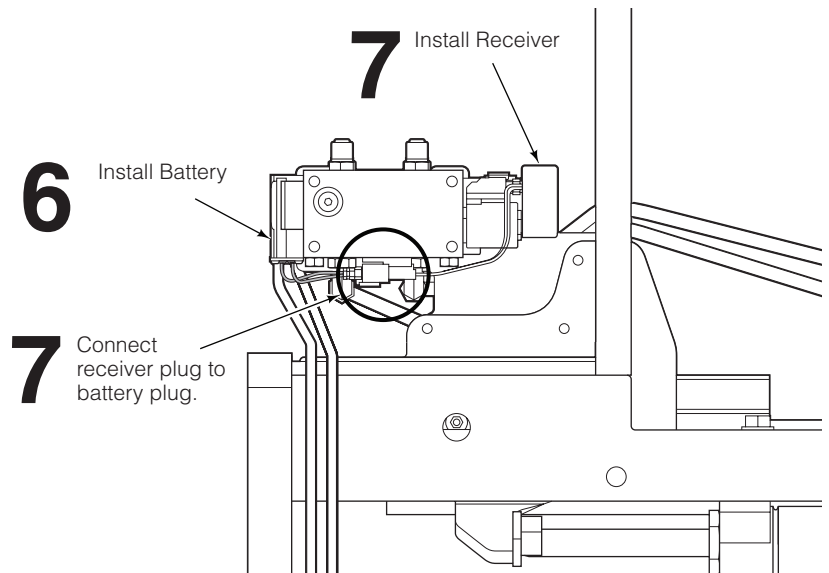

8 Install tubes and supply hoses.

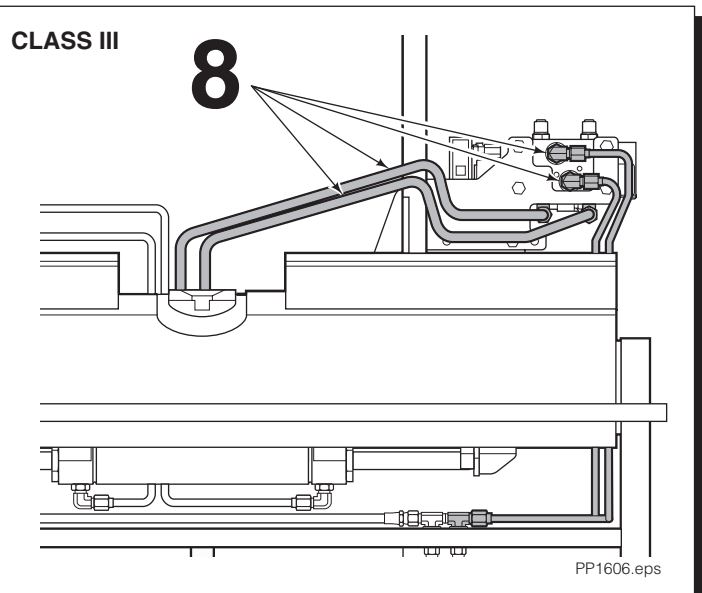
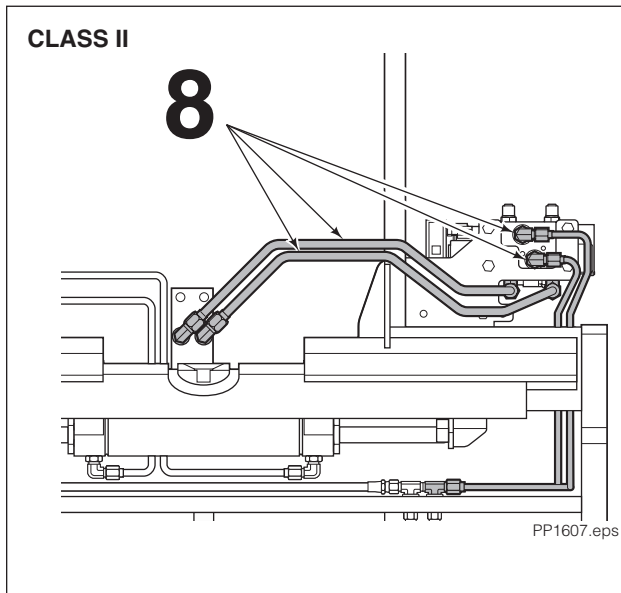

9 Install valve cover and tighten capscrews to 13-15 ft.-lbs. (18-20 Nm).

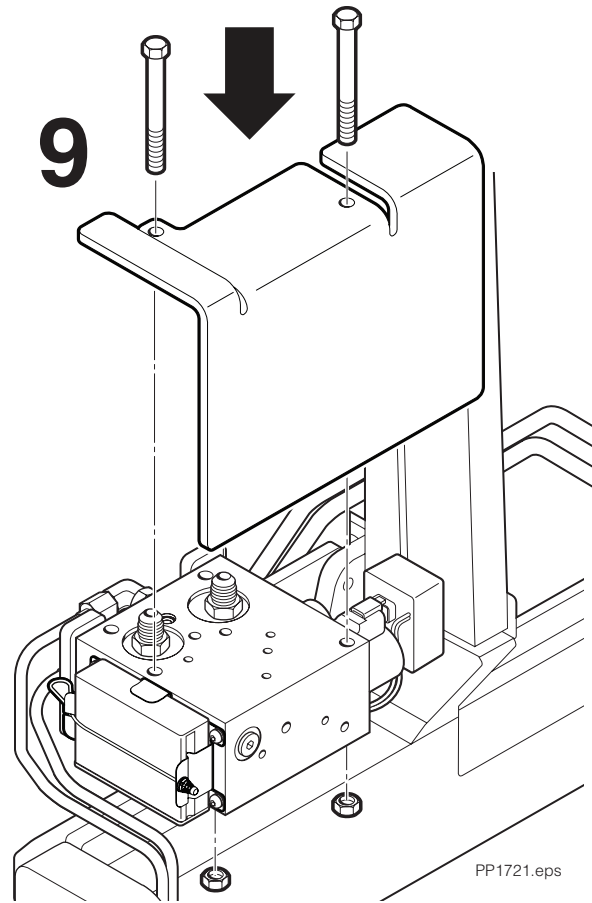

PP1721.eps

10 Control Knob – If kit includes knob, remove existing control knob from the Push/Pull auxiliary valve handle. Install the new knob using the adapter provided.

CAUTION: Secure the cable so it will not be pinched when the handle is actuated.

Switch –

10

NOTE: Shrink tubing may be removed around button as desired

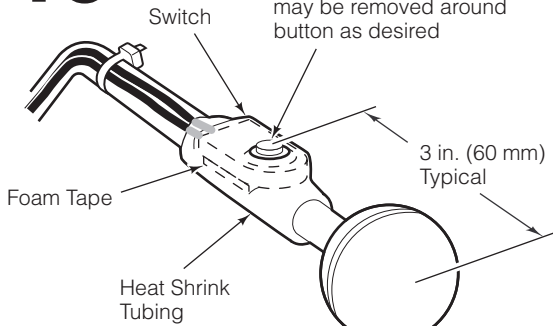

AC0898.eps

10

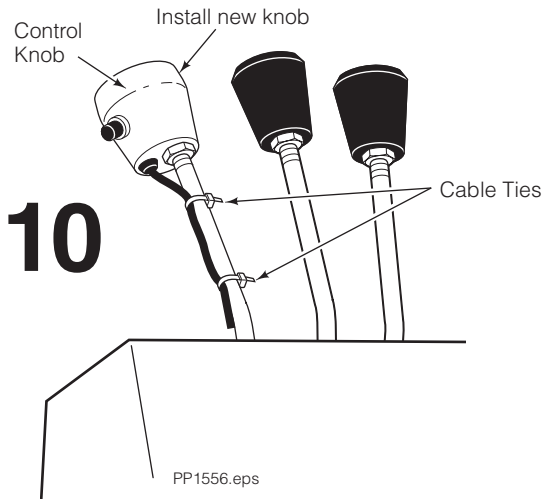

PP1556.eps

Transmitter Installation

1 Install the transmitter above dashboard in an easy to view and accessible location for the driver. Provide at least 8 in. (20 cm) clearance between the driver and transmitter.

IMPORTANT: The transmitter must not be co-located or operating in conjunction with any other antenna or transmitter.

2 Connect the transmitter red wire to a switched terminal on the truck fuse block. Connect the black wire to chassis ground. Connect the two remaining wires to a control knob transmit switch. Use Cascade Control Knob Kit 673130 or Switch Kit 6014880.

IMPORTANT: The resistor connected to the red wire is for use on trucks operating at 31V to 80V. Remove the resistor on trucks operating at 30V or less.

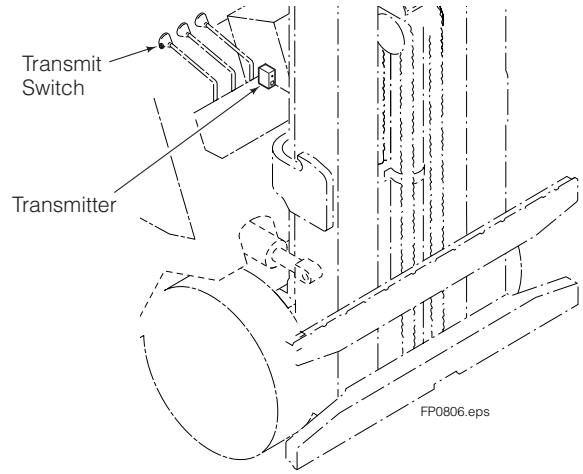

Operation

Verify that the transmitter has been properly connected to truck battery and receiver is plugged into the battery. The light on the transmitter and receiver will operate as follows:

- No signal light: Check transmitter supply voltage. If transmitter voltage is not the problem, install charged battery on the receiver.
- Solid/flashing green: Transmitter and receiver have adequate power and are working properly.
- Solid/flashing red: Receiver battery is low, replace with charged battery.

NOTE: After one hour of inactivity, the receiver goes into sleep mode to conserve power. Press and hold the transmit switch for two seconds to wake the unit for operation.

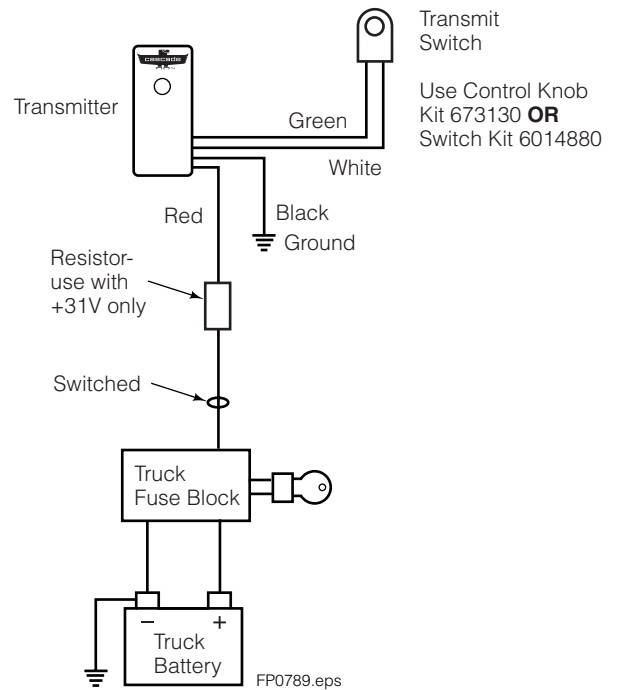

Battery

NOTE: Charge new batteries prior to use.

Chargers available are listed:

Location	Battery Charger
	Part No.
North America	6079239
Australia	6079700
United Kingdom	6079701
Europe	6079699

Voltage switch on the charger should be set to 10.8V/11.1V.

Hydraulic Control Kit

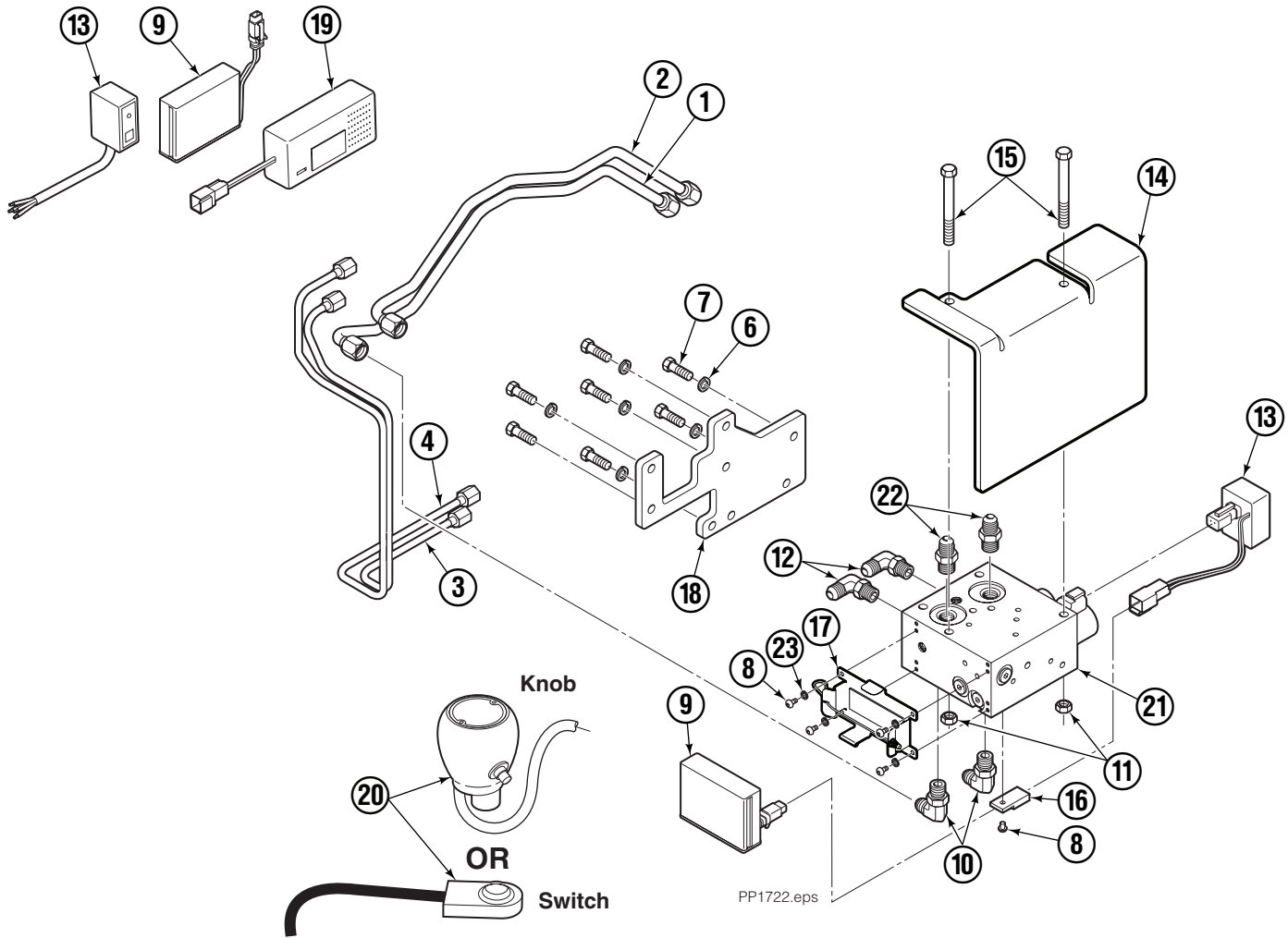

REF	QTY	PART NO.	DESCRIPTION	REF	QTY	PART NO.	DESCRIPTION
		6086562	RF Solenoid Adaption Kit – CL III	9	2	6075736	Battery
		6090114	RF Solenoid Adaption Kit Low Profile – CL III	10	2	601676	Fitting, No. 6-6 90° Elbow
		6095181	RF Solenoid Adaption Kit – CL II	11	2	767414	Nut, M8
		6095182	RF Solenoid Adaption Kit Low Profile – CL II	12	2	666984	Fitting, JIC No. 4-6 90° Elbow
		6095183	RF Solenoid Conversion Kit – CL II	13	1	6068961	RF Transmission Kit
1	1	6095161 ◆ 6086539 ■	Tube Assembly	14	1	6095158	Valve Protection Bracket
2	1	6095160 ◆ 6086538 ■	Tube Assembly	15	2	6405022	Capscrew, M8 x 80
3	1	6095162 ◆ 6086541 ■	Tube Assembly	16	1	6079201	Receiver Clip
4	1	6095163 ◆ 6086540 ■	Tube Assembly	17	1	6094986	Battery Clip
6	✘	787384	Lockwasher, M8	18	1	6095159	Bracket
7	✘	787372	Capscrew, M8 x 20	19	1	6079239	Battery Charger, Lithium Ion
8	5	6076098	Button Head Capscrew, M4	20	1	355058	Knob Assembly ▲
						6014880	Operator Control Switch Kit ★
				21	1	6070947	Valve Assembly ●
				22	2	604511	Fitting, No. 6-6 Straight
				23	4	685899	Lockwasher, M4

▲ Included with kit 6095181 and 6086562. See Knob Assembly page for parts breakdown.

● See Valve Assembly page for parts breakdown.

◆ Included in kits 6095181, 6095182 and 6095183.

■ Included in kits 6086562 and 6090114.

★ Included with kits 6095182 and 6090114. See Control Switch Kit page for parts breakdown.

✘ Quantity varies per kit.

Control Knob Two Function

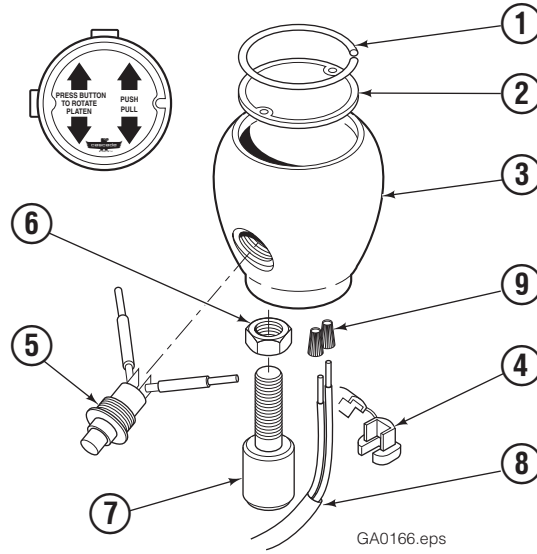

REF	QTY	PART NO.	DESCRIPTION
		355058	Knob Group
1	1	665250	Snap Ring
2	1	355059	Cover
3	1	665012	Knob
4	1	665076	Strain Relief
5	1	677112	Switch ■
6	1	5902	Nut, 3/8 NC
7	1	665081	Adaptor
8	1	667718	Cable Assembly
9	2	667752	Connector – Gray

■ This switch may be purchased without wires. Order part number 665004. Soldering is required.

Low Profile Switch Kit

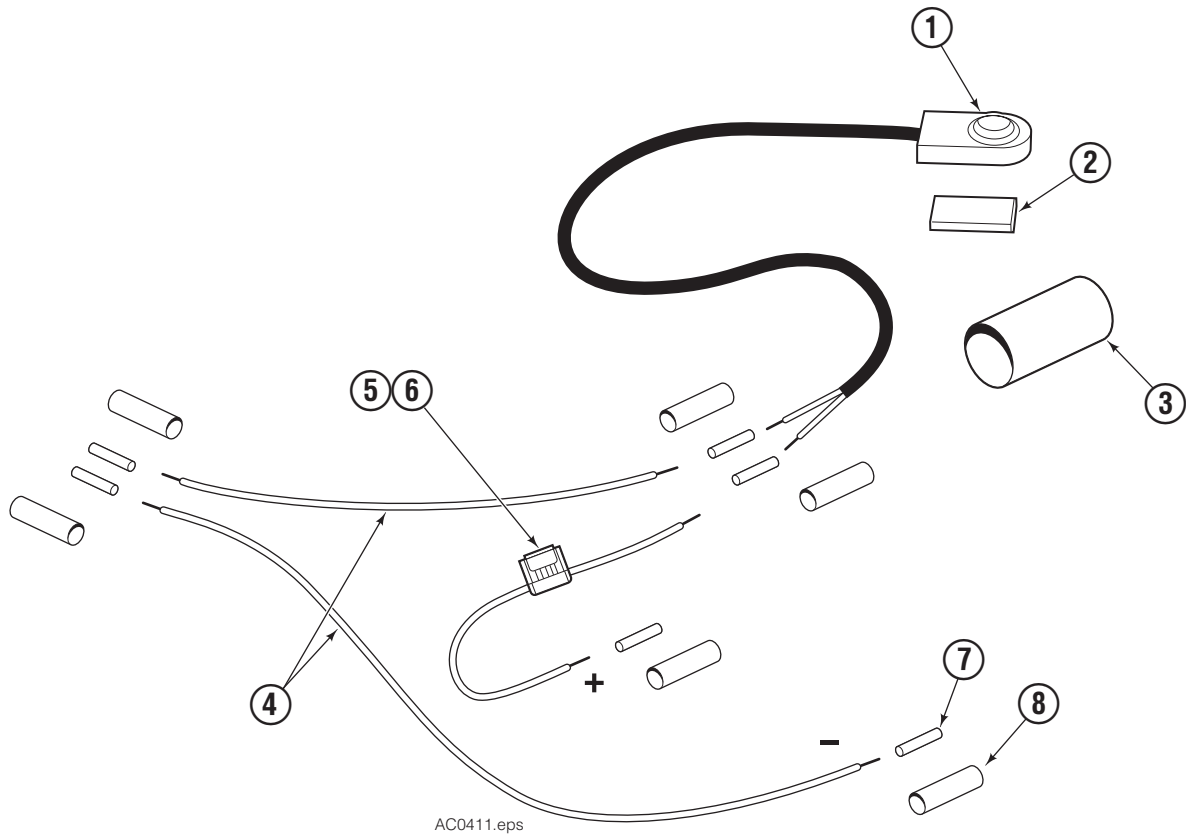

REF	QTY	PART NO.	DESCRIPTION
		6014880	Operator Control Switch Kit
1	1	6009928	Switch
2	1	6014987	Double Sided Tape
3	1	6001641	Shrink Tube
4	1	6014990	Wire – 18 AWG
5	1	228154	Fuse – 7.5 Amp
6	1	219402	Fuse Holder
7	6	6014986	Connector
8	6	6016648	Shrink Tube

Valve Assembly

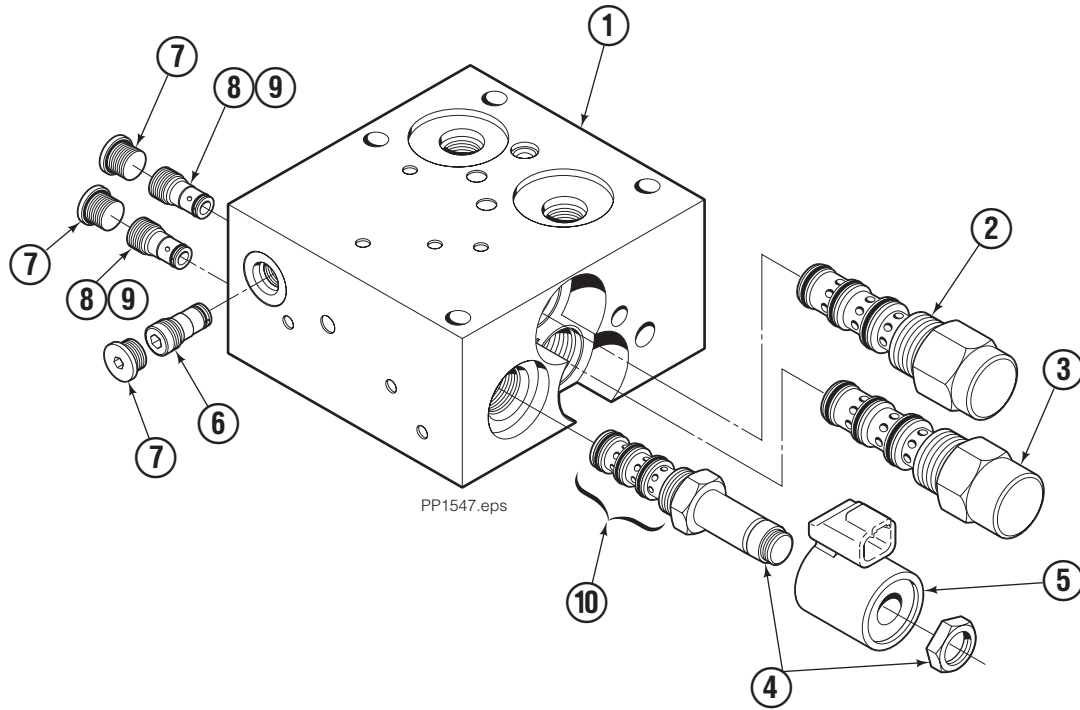

REF	QTY	PART NO.	DESCRIPTION
		6070947	Valve Assembly
1	1	6070946	Valve Body
2	1	6069787	Cartridge
3	1	6069792	Cartridge
4	1	220627	Solenoid Valve Cartridge
5	1	6054451	Solenoid Coil, 10 VDC
6	1	220865	Shuttle Valve
7	3	609234	Plug
8	2	6057940	Check Valve Cartridge
9	2	6025595	Service Kit
10	1	221049	Service Kit

Do you have questions you need answered right now? Call your nearest Cascade Service Department. Visit us online at www.cascorp.com

AMERICAS

**Cascade Corporation
U.S. Headquarters**
2201 NE 201st
Fairview, OR 97024-9718
Tel: 800-CASCADE (227-2233)
Fax: 888-329-8207

Cascade Canada Inc.
5570 Timberlea Blvd.
Mississauga, Ontario
Canada L4W-4M6
Tel: 905-629-7777
Fax: 905-629-7785

Cascade do Brasil
Rua João Guerra, 134
Macuco, Santos - SP
Brasil 11015-130
Tel: 55-13-2105-8800
Fax: 55-13-2105-8899

EUROPE-AFRICA

**Cascade Italia S.R.L.
European Headquarters**
Via Dell'Artigianato 1
37030 Vago di Lavagno (VR)
Italy
Tel: 39-045-8989111
Fax: 39-045-8989160

Cascade (Africa) Pty. Ltd.
PO Box 625, Isando 1600
60A Steel Road
Sparton, Kempton Park
South Africa
Tel: 27-11-975-9240
Fax: 27-11-394-1147

ASIA-PACIFIC

Cascade Japan Ltd.
2-23, 2-Chome,
Kukuchi Nishimachi
Amagasaki, Hyogo
Japan, 661-0978
Tel: 81-6-6420-9771
Fax: 81-6-6420-9777

Cascade Korea
121B 9L Namdong Ind.
Complex, 691-8 Gojan-Dong
Namdong-Ku
Inchon, Korea
Tel: +82-32-821-2051
Fax: +82-32-821-2055

Cascade-Xiamen
No. 668 Yangguang Rd.
Xinyang Industrial Zone
Haicang, Xiamen City
Fujian Province
P.R. China 361026
Tel: 86-592-651-2500
Fax: 86-592-651-2571

**Cascade India Material
Handling Private Limited**
No 34, Global Trade Centre
1/1 Rambaugh Colony
Lal Bahadur Shastri Road,
Navi Peth, Pune 411 030
(Maharashtra) India
Phone: +91 020 2432 5490
Fax: +91 020 2433 0881

Cascade Australia Pty. Ltd.
1445 Ipswich Road
Rocklea, QLD 4107
Australia
Tel: 1-800-227-223
Fax: +61 7 3373-7333

Cascade New Zealand
15 Ra Ora Drive
East Tamaki, Auckland
New Zealand
Tel: +64-9-273-9136
Fax: +64-9-273-9137

**Sunstream Industries
Pte. Ltd.**
18 Tuas South Street 5
Singapore 637796
Tel: +65-6795-7555
Fax: +65-6863-1368

