



A versatile,
high-production
roll clamp for
newsprint and
coated papers.

Specifically designed for printers and newspaper publishers.

APPLICATIONS

Designed for small printers, newspaper publishers and newsprint warehouses.

FEATURES

Reduced Reel Damage

- Very thin arm profile and smooth-arm contour eases reel breakout and permits close stacking
- Proven contact pad shape and surface holds reels securely
- Positioned Short Arm maintains thin-arm profile over a wide range of reel diameters

Faster Reel Handling

- Excellent visibility through and around clamp
- Handles less than full size reels against the bumper for faster handling
- Continuous 360° rotation
- Frame size optimized for one- or two-reel handling

Excellent Durability

- Unitized construction provides structural integrity in arms and frame
- Proven durable rotator drive train
- Pivot bushings are lube-free and provide longer service life
- Large pivot pins for extended life

MODELS

Fixed Frame/Fixed Short Arm

- Excellent arm profile when handling reels near maximum diameter

Fixed Frame/Positioned Short Arm

- Excellent long-arm profile over a wide range of reel diameters

OPTIONS

- Split Arm—the two long arm sections move independently, allowing you to handle two different size reels simultaneously.
- AFC (Adaptive Force Control) for automatic control of clamping pressure that changes as reel weight changes.
- HFC (Hydraulic Force Control) a hydraulically controlled automatic clamp force system that changes clamp force proportional to the load weight.
- 180° mechanical stop group
- Electronic Rotational Control for precise 180° and 90° (bilge) positioning
- Wide variety of rubber, urethane and other pads available for improved handling of all paper types. Rubber or urethane pads are recommended for handling newsprint.

18H-20H PAPER ROLL CLAMP

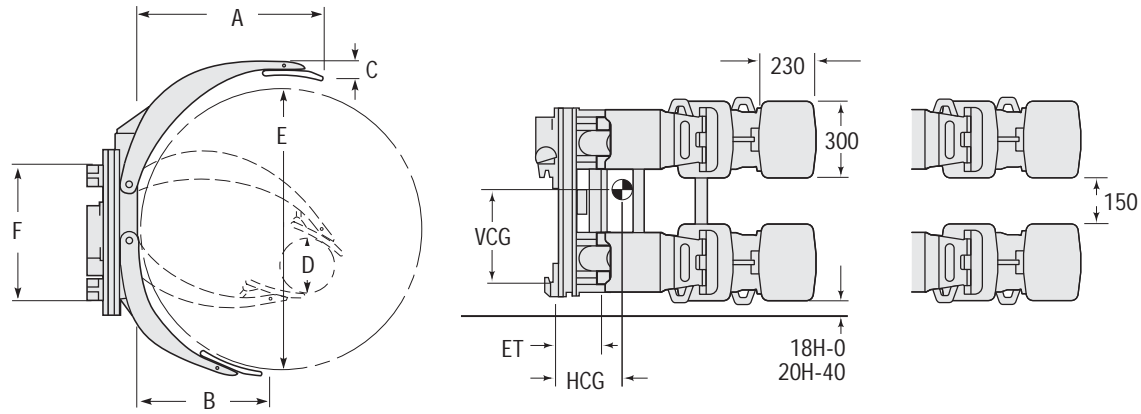

Catalogue Order No.	Capacity @ load centre kg @ mm	Roll Range (mm) D - E	Mounting Class ISO 2328	Mounting Angle 1	Hook Spread (mm) F	Effective Thickness (mm) ET	Horizontal Centre of Gravity (mm) HCG	Vertical Centre of Gravity (mm) VCG	Weight kg	Long Arm Length A	Short Arm Length B	Long Arm Thickness C
Solid Long Arm - Positioned Short Arm												
18H-RBP-A011	2000 @ 575	200-1150	2A	0°	535	159	238	296	428	724	532	46
18H-RBP-A013	1800 @ 650	200-1300	2A	0°	535	159	257	296	457	818	591	46
18H-RBP-A015	1600 @ 700	200-1400	2A	0°	535	159	273	296	473	878	630	46
20H-RBP-A011	2250 @ 575	200-1150	2A	0°	805	180	223	340	522	724	532	46
20H-RBP-B011	2250 @ 575	200-1150	3A	0°	805	214	252	335	533	724	532	46
20H-RBP-A013	2000 @ 650	200-1300	2A	0°	805	180	256	340	528	818	591	46
20H-RBP-B013	2000 @ 650	200-1300	3A	0°	805	214	282	335	540	818	591	46
20H-RBP-A015	1850 @ 700	200-1400	2A	0°	805	180	265	340	553	878	633	46
20H-RBP-B015	1850 @ 700	200-1400	3A	0°	805	214	290	335	562	878	633	46
Solid Long Arm - Fixed Short Arm												
18H-RBF-A011	2000 @ 575	450-1150	2A	0°	535	159	239	296	422	724	532	46
18H-RBF-A013	1800 @ 650	450-1300	2A	0°	535	159	259	296	451	818	591	46
18H-RBF-A015	1600 @ 700	450-1400	2A	0°	535	159	275	296	467	878	630	46
20H-RBF-A011	2250 @ 575	450-1150	2A	0°	805	180	223	340	515	724	532	46
20H-RBF-B011	2250 @ 575	450-1150	3A	0°	805	214	252	335	526	724	532	46
20H-RBF-A013	2000 @ 650	450-1300	2A	0°	805	180	256	340	522	818	591	46
20H-RBF-B013	2000 @ 650	450-1300	3A	0°	805	214	282	335	533	818	591	46
20H-RBF-A015	1850 @ 700	450-1400	2A	0°	805	180	265	340	549	878	533	46
20H-RBF-B015	1850 @ 700	450-1400	3A	0°	805	214	290	335	558	878	533	46
Split Long Arm - Positioned Short Arm												
18H-REP-A011	2000 @ 575	200-1150	2A	0°	535	159	234	296	421	724	532	46
18H-REP-A013	1800 @ 650	200-1300	2A	0°	535	159	254	296	450	818	591	46
18H-REP-A015	1600 @ 700	200-1400	2A	0°	535	159	270	296	466	878	630	46
20H-REP-A011	2250 @ 575	200-1150	2A	0°	805	180	223	340	515	724	532	46
20H-REP-B011	2250 @ 575	200-1150	3A	0°	805	214	252	335	526	724	532	46
20H-REP-A013	2000 @ 650	200-1300	2A	0°	805	180	256	340	522	818	591	46
20H-REP-B013	2000 @ 650	200-1300	3A	0°	805	214	282	335	533	818	591	46
20H-REP-A015	1850 @ 700	200-1400	2A	0°	805	180	265	340	547	878	633	46
20H-REP-B015	1850 @ 700	200-1400	3A	0°	805	214	290	335	556	878	633	46
Split Long Arm - Fixed Short Arm												
18H-REF-A011	2000 @ 575	450-1150	2A	0°	535	159	236	296	415	724	532	46
18H-REF-A013	1800 @ 650	450-1300	2A	0°	535	159	256	296	444	818	591	46
18H-REF-A015	1600 @ 700	450-1400	2A	0°	535	159	273	296	460	878	630	46
20H-REF-A011	2250 @ 575	450-1150	2A	0°	805	180	223	340	508	724	532	46
20H-REF-B011	2250 @ 575	450-1150	3A	0°	805	214	252	335	519	724	532	46
20H-REF-A013	2000 @ 650	450-1300	2A	0°	805	180	256	340	515	818	591	46
20H-REF-B013	2000 @ 650	450-1300	3A	0°	805	214	282	335	526	818	591	46
20H-REF-A015	1850 @ 700	450-1400	2A	0°	805	180	265	340	542	878	533	46
20H-REF-B015	1850 @ 700	450-1400	3A	0°	805	214	290	335	551	878	533	46

① 2° mounting available. Consult Cascade.

▶ Full height contact pads are available. Consult Cascade for catalogue order number.

▶ Model shown is with Herringbone contact pads. RXH pads are available upon request.

▶ All models come standard with 360° rotation. A 180° Stop Group is also available.

HYDRAULIC FLOW & PRESSURE (L/MIN.)

Model	Minimum Flow	Recommended Flow	Maximum Flow	Maximum Pressure
18H	19	32	45	160 bar
20H	19	38	57	160 bar

HYDRAULIC FUNCTIONS

Model	Hydraulic Functions	Truck Auxiliary Valves Required
Fixed short arm	2	2
Positioned short arm	2	2

Cascade (UK) Ltd • 3 Kelbrook Road • Parkhouse Industrial Estate • Openshaw • Manchester M11 2DD • England • Tel. (free phone) 0800 243015 • Fax. +44-(0)161 438 4055
 Cascade European Headquarters • Via Dell'Artigianato 1 • 37050 Vago di Lavagno (VR) • Italy • Tel. +39-045-8989111 • Fax +39-045-8989160

cascade
EUROPE

Cascade is a registered trademark of Cascade Corporation.
 © Cascade Corporation 2010. All rights reserved.

www.cascorp.com

Form 6805874_GB 01/10