



*Thin arm profile  
for easier knifing  
in between rolls.*

## Superior arm and pad profile

### APPLICATIONS

The H-Series Roll Clamp was designed with a thinner pad profile to eliminate damage while knifing in between rolls in containers, trailers and rail cars. Excellent visibility through the arms and frame allow for maximum productivity and reduced damage.

### FEATURES

- Ultra thin profile pads with Herringbone surface
- Excellent visibility through arms
- Optimized pad height to maximize range of roll sizes
- Heavy-duty rotator drivetrain proven to provide superior durability
- Split arm or solid arm
- Fast arm speed
- Pad protectors
- Fixed or positionable short arm
- 45° short arm positioning
- 360° or 180° rotation
- New pad alignment system utilizing dual spring technology holds the contact pads in proper alignment

### OPTIONS

- RXH & UDP surface contact pads
- Adaptive Force Control (AFC)
- Full height contact pads (non-split)
- Quick-Disconnect Hooks
- Sequenced short arm positioning



# 25H PIVOT ARM ROLL CLAMP

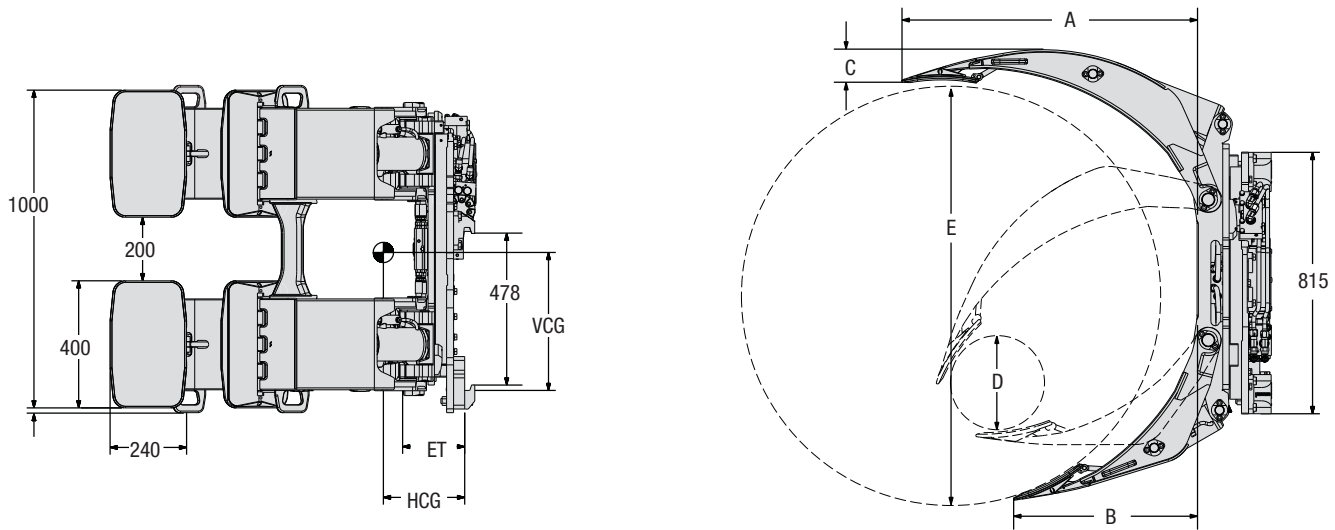

Model shown is with Herringbone contact pads. RXH pads are available upon request.

Model	Capacity @ Load Centre kg@mm	Roll Range (mm) D-E	Minimum Truck Carriage Width (mm) F	Mtg Class / Mtg Angle ISO-2328	Weight kg	Effective Thickness (mm) ET	Horizontal Centre of Gravity (mm) HCG	Vertical Centre of Gravity (mm) VCG	Long Arm Length (mm) A	Short Arm Length (mm) B	Long Arm Thickness (mm) C
<b>Fixed Frame / Solid Arm - Positioned Short Arm</b>											
25H-RBP-B031	2,500 @ 650	200 - 1300	815	3A-0°	718	195	267	425	906	575	42.5
25H-RBP-B033	2,300 @ 700	200 - 1400	815	3A-0°	724	195	276	426	953	625	42.5
25H-RBP-B035	2,100 @ 763	200 - 1525	815	3A-0°	754	195	290	427	1005	695	42.0
25H-RBP-B037	2,050 @ 800	200 - 1600	815	3A-0°	750	195	300	427	1003	739	47.3
<b>Fixed Frame / Split Arm - Positioned Short Arm</b>											
25H-REP-B031	2,500 @ 650	200 - 1300	815	3A-0°	708	195	264	426	906	575	42.5
25H-REP-B033	2,300 @ 700	200 - 1400	815	3A-0°	714	195	273	426	953	625	42.5
25H-REP-B035	2,100 @ 763	200 - 1525	815	3A-0°	744	195	289	427	1005	695	42.0
25H-REP-B037	2,050 @ 800	200 - 1600	815	3A-0°	758	195	297	427	1003	739	47.3
<b>Fixed Frame / Solid Arm - Fixed Short Arm</b>											
25H-RBF-B031	2,500 @ 650	450 - 1300	815	3A-0°	697	195	264	426	906	575	42.5
25H-RBF-B033	2,300 @ 700	575 - 1400	815	3A-0°	715	195	277	426	953	625	42.5
25H-RBF-B035	2,100 @ 763	575 - 1525	815	3A-0°	745	195	291	427	1005	695	42.0
25H-RBF-B037	2,050 @ 800	625 - 1600	815	3A-0°	759	195	301	427	1003	739	47.3
<b>Fixed Frame / Split Arm - Fixed Short Arm</b>											
25H-REF-B031	2,500 @ 650	450 - 1300	815	3A-0°	687	195	261	426	906	575	42.5
25H-REF-B033	2,300 @ 700	575 - 1400	815	3A-0°	705	195	274	426	953	625	42.5
25H-REF-B035	2,100 @ 763	575 - 1525	815	3A-0°	735	195	288	427	1005	695	42.0
25H-REF-B037	2,050 @ 800	625 - 1600	815	3A-0°	749	195	298	427	1003	739	47.3

- ▶ Full height contact pads are available. Consult Cascade for catalog order number.
- ▶ All models can also be configured with a swing frame. These clamps require a Control Valve Group and 3-function hosing over the mast.
- ▶ All models come standard with 360° rotation. A 180° Stop Group is also available.

## ROTATOR SPECIFICATIONS

Rotator Speed
7 RPM @ 38 L-min

▶ Optional motors providing increased torque are available. Reduced speed will result.

## HYDRAULIC FLOW & PRESSURE

Min. Flow	Recommended Flow	Max. Flow	Max. Pressure
19 L-min	38 L-min	57 L-min	160 BAR

## HYDRAULIC FUNCTIONS

Model	Hydraulic Functions	Truck Aux. Valves Required
Positioned / Fixed Short Arm	2	2

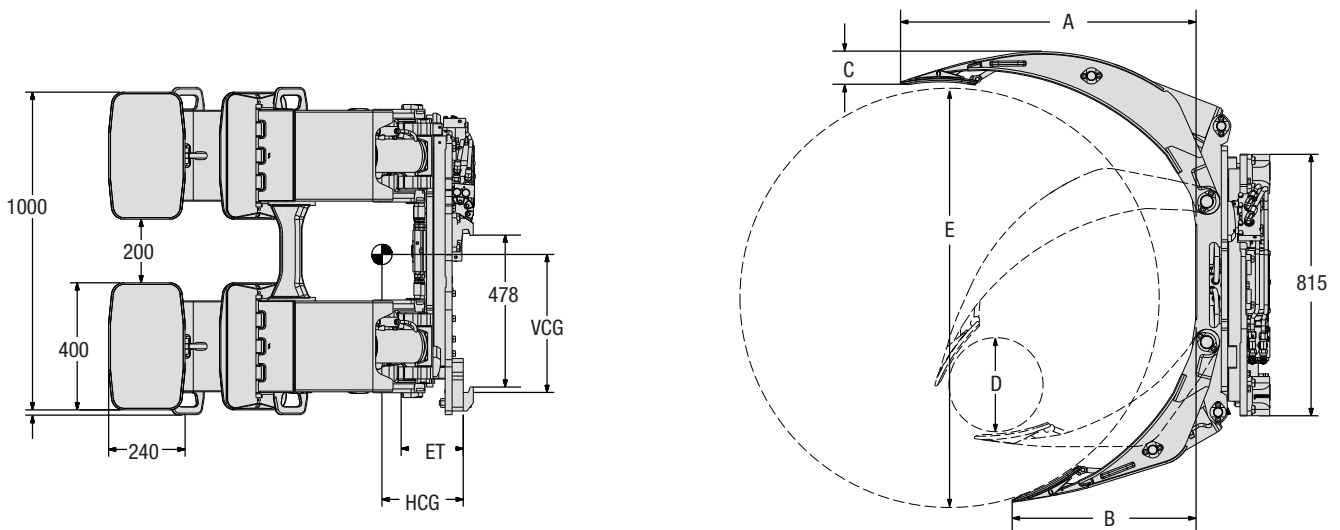

Model shown is with Herringbone contact pads. RXH pads are available upon request.

Model	Capacity @ Load Centre kg@mm	Roll Range (mm) D-E	Minimum Truck Carriage Width (mm) F	Mtg Class / Mtg Angle ISO 2328	Weight kg	Effective Thickness (mm) ET	Horizontal Centre of Gravity (mm) HCG	Vertical Centre of Gravity (mm) VCG	Long Arm Length (mm) A	Short Arm Length (mm) B	Long Arm Thickness (mm) C	
<b>Fixed Frame / Solid Arm - Positioned Short Arm</b>												
30H-RBP-B031	3,000 @ 650	200 - 1300	815	3A-0°	735	195	269	426	906	575	42.5	
30H-RBP-B033	2,800 @ 700	200 - 1400	815	3A-0°	742	195	277	426	953	625	42.5	
30H-RBP-B035	2,550 @ 763	200 - 1525	815	3A-0°	772	195	292	427	1005	695	41.9	
30H-RBP-B037	2,450 @ 800	200 - 1600	815	3A-0°	789	195	302	427	1098	835	47.3	
30H-RBP-B039	2,150 @ 915	200 - 1830	815	3A-0°	852	195	333	428	1153	845	44.0	
<b>Fixed Frame / Split Arm - Positioned Short Arm</b>												
30H-REP-B031	3,000 @ 650	200 - 1300	815	3A-0°	725	195	266	426	906	575	42.5	
30H-REP-B033	2,800 @ 700	200 - 1400	815	3A-0°	732	195	274	426	953	625	42.5	
30H-REP-B035	2,550 @ 763	200 - 1525	815	3A-0°	762	195	289	426	1005	695	41.9	
30H-REP-B037	2,450 @ 800	200 - 1600	815	3A-0°	779	195	299	427	1098	835	47.3	
30H-REP-B039	2,150 @ 915	200 - 1830	815	3A-0°	842	195	330	428	1153	845	44.0	
<b>Fixed Frame / Solid Arm - Fixed Short Arm</b>												
30H-RBF-B031	3,000 @ 650	450 - 1300	815	3A-0°	714	195	266	426	906	575	42.5	
30H-RBF-B033	2,800 @ 700	575 - 1400	815	3A-0°	732	195	278	426	953	625	42.5	
30H-RBF-B035	2,550 @ 763	575 - 1525	815	3A-0°	763	195	293	426	1005	695	41.9	
30H-RBF-B037	2,450 @ 800	625 - 1600	815	3A-0°	780	195	303	427	1098	835	47.3	
30H-RBF-B039	2,150 @ 915	625 - 1830	815	3A-0°	845	195	335	427	1153	845	44.0	
<b>Fixed Frame / Split Arm - Fixed Short Arm</b>												
30H-REF-B031	3,000 @ 650	450 - 1300	815	3A-0°	704	195	263	426	906	575	42.5	
30H-REF-B033	2,800 @ 700	575 - 1400	815	3A-0°	722	195	275	426	953	625	42.5	
30H-REF-B035	2,550 @ 763	575 - 1525	815	3A-0°	752	195	290	426	1005	695	41.9	
30H-REF-B037	2,450 @ 800	625 - 1600	815	3A-0°	770	195	300	427	1098	835	47.3	
30H-REF-B039	2,150 @ 915	625 - 1830	815	3A-0°	835	195	332	427	1153	845	44.0	

- ▶ Full height contact pads are available. Consult Cascade for catalog order number.
- ▶ Class IV Mounting also available on all 30H Models. Consult Cascade.
- ▶ All models can also be configured with a swing frame. These clamps require a Control Valve Group and 3-function hosing over the mast.
- ▶ All models come standard with 360° rotation. A 180° Stop Group is also available.

## ROTATOR SPECIFICATIONS

### Rotator Speed

7 RPM @ 38 L-min

- ▶ Optional motors providing increased torque are available. Reduced speed will result.

## HYDRAULIC FLOW & PRESSURE

Min. Flow	Recommended Flow	Max. Flow	Max. Pressure
19 L-min	38 L-min	57 L-min	160 BAR

## HYDRAULIC FUNCTIONS

Model	Hydraulic Functions	Truck Aux. Valves Required
Positioned / Fixed Short Arm	2	2

# 33H PIVOT ARM ROLL CLAMP

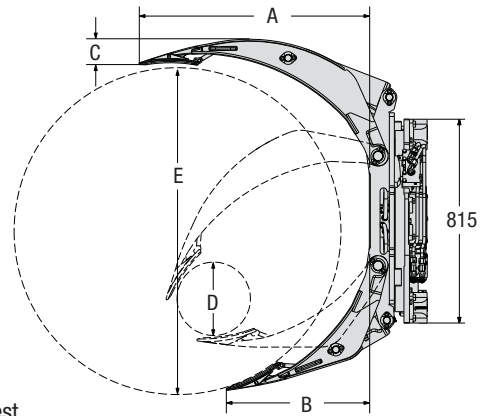
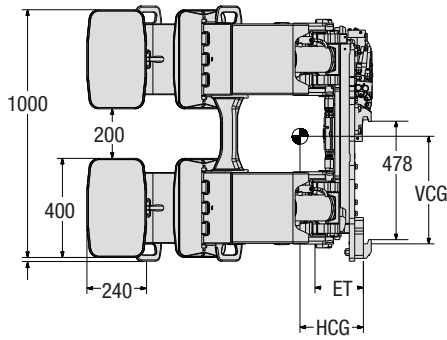

Model shown is with Herringbone contact pads. RXH pads are available upon request.

Model	Capacity @ Load Centre kg@mm	Roll Range (mm) D-E	Minimum Truck Carriage Width (mm) F	Mtg Class / Mtg Angle ISO-2328	Weight kg	Effective Thickness (mm) ET	Horizontal Centre of Gravity (mm) HCG	Vertical Centre of Gravity (mm) VCG	Long Arm Length (mm) A	Short Arm Length (mm) B	Long Arm Thickness (mm) C
<b>Fixed Frame / Solid Arm - Positioned Short Arm</b>											
33H-RBP-B031	3,500 @ 650	200 - 1300	815	3A - 0°	766	208	266	427	906	575	43
33H-RBP-C031	3,500 @ 650	200 - 1300	974	4A - 0°	827	253	290	378	906	575	43
33H-RBP-B033	3,300 @ 700	200 - 1400	815	3A - 0°	774	208	274	427	953	624	43
33H-RBP-C033	3,300 @ 700	200 - 1400	974	4A - 0°	830	253	293	378	953	624	43
33H-RBP-B035	3,000 @ 763	200 - 1525	815	3A - 0°	801	208	287	427	1005	695	42
33H-RBP-C035	3,000 @ 763	200 - 1525	974	4A - 0°	862	253	311	379	1005	695	42
33H-RBP-B037	2,850 @ 800	200 - 1600	815	3A - 0°	821	208	297	427	1002	739	47
33H-RBP-C037	2,850 @ 800	200 - 1600	974	4A - 0°	882	253	320	379	1002	739	47
33H-RBP-B039	2,500 @ 915	200 - 1830	815	3A - 0°	883	208	327	428	1117	1046	50
33H-RBP-C039	2,500 @ 915	200 - 1830	974	4A - 0°	939	253	352	380	1117	1046	50
<b>Fixed Frame / Split Arm - Positioned Short Arm</b>											
33H-REP-B031	3,500 @ 650	200 - 1300	815	3A - 0°	756	208	263	427	906	575	43
33H-REP-C031	3,500 @ 650	200 - 1300	974	4A - 0°	817	253	287	378	906	575	43
33H-REP-B033	3,300 @ 700	200 - 1400	815	3A - 0°	764	208	271	427	953	624	43
33H-REP-C033	3,300 @ 700	200 - 1400	974	4A - 0°	820	253	289	378	953	624	43
33H-REP-B035	3,000 @ 763	200 - 1525	815	3A - 0°	791	208	284	427	1005	695	42
33H-REP-C035	3,000 @ 763	200 - 1525	974	4A - 0°	852	253	308	379	1005	695	42
33H-REP-B037	2,850 @ 800	200 - 1600	815	3A - 0°	811	208	294	427	1002	739	47
33H-REP-C037	2,850 @ 800	200 - 1600	974	4A - 0°	872	253	317	379	1002	739	47
33H-REP-B039	2,500 @ 915	200 - 1830	815	3A - 0°	873	208	324	428	1117	1046	50
33H-REP-C039	2,500 @ 915	200 - 1830	974	4A - 0°	933	253	347	379	1117	1046	50
<b>Fixed Frame / Solid Arm - Fixed Short Arm</b>											
33H-RBF-B031	3,500 @ 650	425 - 1300	815	3A - 0°	746	208	263	426	906	575	43
33H-RBF-C031	3,500 @ 650	425 - 1300	974	4A - 0°	806	253	287	378	906	575	43
33H-RBF-B033	3,300 @ 700	500 - 1400	815	3A - 0°	764	208	274	427	953	624	43
33H-RBF-C033	3,300 @ 700	500 - 1400	974	4A - 0°	820	253	293	378	953	624	43
33H-RBF-B035	3,000 @ 763	575 - 1525	815	3A - 0°	792	208	288	427	1005	695	42
33H-RBF-C035	3,000 @ 763	575 - 1525	974	4A - 0°	852	253	311	379	1005	695	42
33H-RBF-B037	2,850 @ 800	575 - 1600	815	3A - 0°	812	208	298	427	1002	739	47
33H-RBF-C037	2,850 @ 800	575 - 1600	974	4A - 0°	873	253	321	379	1002	739	47
33H-RBF-B039	2,500 @ 915	600 - 1830	815	3A - 0°	875	208	328	428	1117	1046	50
33H-RBF-C039	2,500 @ 915	600 - 1830	974	4A - 0°	931	253	352.7	379	1117	1046	50
<b>Fixed Frame / Split Arm - Fixed Short Arm</b>											
33H-REF-B031	3,500 @ 650	425 - 1300	815	3A - 0°	736	208	260	426	906	575	43
33H-REF-C031	3,500 @ 650	425 - 1300	974	4A - 0°	796	253	283	378	906	575	43
33H-REF-B033	3,300 @ 700	500 - 1400	815	3A - 0°	754	208	271	426	953	624	43
33H-REF-C033	3,300 @ 700	500 - 1400	974	4A - 0°	810	253	289	378	953	624	43
33H-REF-B035	3,000 @ 763	575 - 1525	815	3A - 0°	782	208	285	427	1005	695	42
33H-REF-C035	3,000 @ 763	575 - 1525	974	4A - 0°	842	253	308	378	1005	695	42
33H-REF-B037	2,850 @ 800	575 - 1600	815	3A - 0°	802	208	295	427	1002	739	47
33H-REF-C037	2,850 @ 800	575 - 1600	974	4A - 0°	863	253	318	379	1002	739	47
33H-REF-B039	2,500 @ 915	600 - 1830	815	3A - 0°	865	208	325	428	1117	1046	50
33H-REF-C039	2,500 @ 915	600 - 1830	974	4A - 0°	926	253	348	379	1117	1046	50

- ▶ Full height contact pads are available. Consult Cascade for catalog order number.
- ▶ All models can also be configured with a swing frame. These clamps require a Control Valve Group and 3-function hosing over the mast.
- ▶ Please see inside pages for Rotator specifications and hydraulic information.
- ▶ All models come standard with 360° rotation. A 180° Stop Group is also available.

Cascade (UK) Ltd • 3 Kelbrook Road • Parkhouse Industrial Estate • Openshaw • Manchester M11 2DD • England • Tel. (free phone) 0800 243015 • Fax. +44-(0)161 438 4055  
 Cascade Europe • Damsluisweg 56 • PO Box 3009 • 1300 EL Almere, Netherlands • Tel +31 (0) 36 54 92 950 • Fax +31 (0) 36 54 92 974