



Protection from damage due to slack lift chains

*Prevents chain
slack and
subsequent
dropping of the
carriage which
causes damage to
the load.*

APPLICATIONS

Cascade's newly updated Drop Stop Valve has been redesigned into a single cartridge style valve that will prevent chain slack on all two, three and four stage masts with forks or attachments. The Drop Stop Valve is effective only when the mast carriage is in freelift.

Damage is caused by the tendency for a lift truck driver to hold the lowering control valve open after the load has been safely deposited. This over-riding causes slack in the lift chain and subsequent dropping of the carriage which causes damage to the load from the forks or attachment arms.



Photo (above) shows damage caused when arm drops due to slack in the chains. This situation can be eliminated with Cascade's Drop Stop Valve. The savings in one day can pay for the added cost.

DROP STOP VALVE

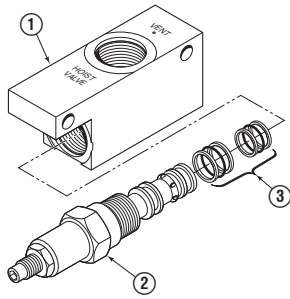

| REF | QTY | PART NO. | DESCRIPTION |
|-----|-----|----------------|--------------------|
| | 1 | 6044220 | Valve Assembly Kit |
| | 1 | 6035205 | Valve Assembly |
| 1 | 1 | 6035204 | Valve Body |
| 2 | 1 | 6035203 | Cartridge |
| 3 | 1 | 6041329 | Cartridge Seal Kit |

| | | | |
|----------------------------------|---|---------------|-----------------------------------|
| For Installation of #8 Hose Use | 2 | 611290 | Straight Thread O-Ring Male Conn. |
| For Installation of #10 Hose Use | 2 | 611292 | Straight Thread O-Ring Male Conn. |
| For Installation Of #12 Hose Use | 2 | 611293 | Straight Thread O-Ring Male Conn. |

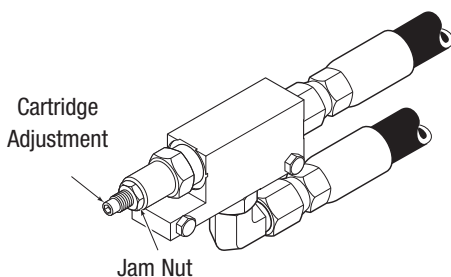
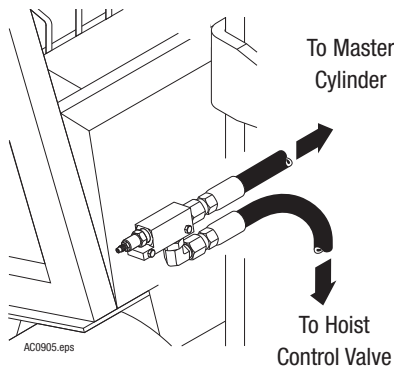
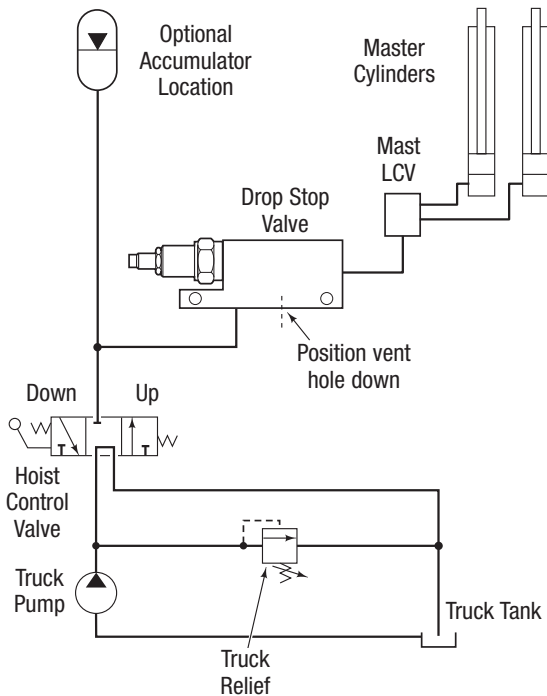

Installation

Must be installed in hoist line between the hoist control valve and the mast lowering control valve. When accumulator is used, install device between accumulator and freight cylinder.

Mounting

Mount on any convenient area of the truck such as the front or back of the cowl. It is preferable to have the vent hole pointed down.

This sheet provides installation instructions and replacement parts list for the Cascade Drop Stop Valve. The valve eliminates slack in the mast lift chains and subsequent drop of the carriage and clamp or forks when the load is released. This is caused by holding the lowering control valve open after the load has been deposited. The Drop Stop Valve is effective only when used in freelif situations.

- 1 Determine a valve mounting location on the truck cowl, under the floorboard or on the mast. The valve must clear the mast when fully tilted back.
- 2 Mount the valve using 3/8 in. (9 mm) dia. capscrews (user supplied). **Position the valve vent hole downward.**
- 3 Make two No. 12 hoses to connect the valve between the hoist control valve and mast lowering control valve. Install the hoses and fittings.
- 4 If an accumulator will be installed in the circuit, install it between the hoist control valve and drop stop valve.

Valve Adjustment

- 1 Loosen the jam nut (3/4 in. hex) on the valve cartridge. Use a 1/4 in. Allen wrench to turn the adjustment screw CCW until internal spring tension is released.
- 2 Cycle the mast several times to remove air in supply line.
- 3 Raise the mast carriage 3 ft. (90 cm) off the floor, then lower to the floor. Turn the cartridge adjustment screw CW 1/2 turn.
- 4 Repeat step 3 until the carriage lowering speed starts to slow. This will be the maximum setting.

Valve Operation

After setting the maximum setting:

- 1 Raise the truck carriage approximately 1 ft. (30 cm) and block under the carriage or attachment. Lower onto the block.
 - 2 Actuate the truck hoist lever in the lowering position for 15 seconds.
The Drop Stop Valve is functioning correctly if the hoist chains are tight when the carriage or attachment is lowered onto the block and the hoist lowering lever is activated.
- If the chains are slack, turn the cartridge adjustment screw 1/2 turn CW and retest until the chains are tight.
- 3 Tighten the cartridge jam nut.