



*Designed
for handling
small rolls of
newsprint,
form and
printing stock.*

Specifically designed for printers and newspaper publishers.

APPLICATIONS

Cascade's 25F Paper Roll Clamp is designed for newspaper publishers, printers and warehouses handling smaller rolls of newsprint, form and printing stock. The 25F is application rated and field proven for newsprint, forms and printing paper roll handling operations. Models are available with capacities up to 1,300 kgs. and roll diameters of 1,600 mm.

OPTIONS

- Wide variety of rubber, urethane and other pads are available for improved handling of certain papers

FEATURES

Reduced Roll Damage

- Proven contact pad shape and surface holds rolls securely
- Thin-arm profile with smooth-arm contour eases roll breakout and permits close stacking

Fast Roll Handling

- Continuous 360° rotation

Excellent Durability

- Unitized construction provides structural integrity in arms and frame
- Proven heavy-duty rotator drive train
- Drive group is protected by the base structure
- Pivot bushings are lube-free and provide longer service life

MODELS

Fixed frame/fixed short arm

- Good arm profile when handling rolls near maximum diameter



25F PAPER ROLL CLAMP

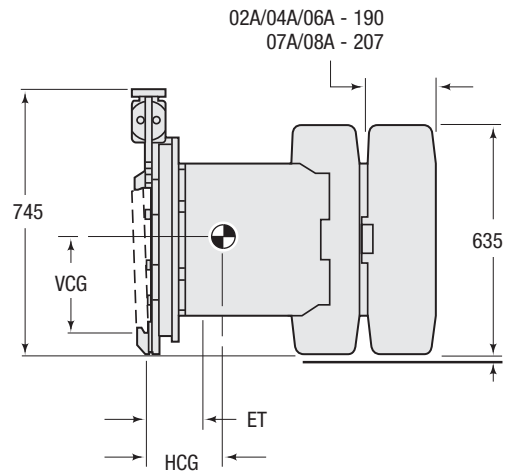
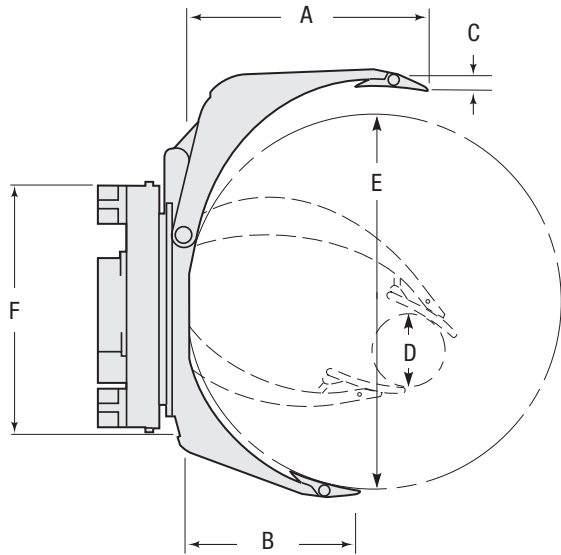

Catalogue Order No.	Capacity @ load centre kg @ mm	Roll Range (mm) D - E	Mounting Class ISO 2328	Mounting Angle [⊙]	Hook Spread OTO (mm) F	Effective Thickness (mm) ET	Horizontal Centre of Gravity (mm) HCG	Vertical Centre of Gravity (mm) VCG	Weight kg	Long Arm Length A	Short Arm Length B	Long Arm Thickness C
Solid Long Arm - Fixed Short Arm												
25F-RCF-A02	1300 @ 535	250-1070	2A	1.5°	610	135	210	330	335	685	480	46
25F-RCF-A04	1300 @ 575	330-1150	2A	1.5°	610	135	345	330	345	685	515	46
25F-RCF-A06	1200 @ 650	400-1300	2A	1.5°	610	135	220	330	355	790	580	46
25F-RCF-A07	1100 @ 750	450-1500	2A	1.5°	610	150	270	330	435	956	658	46
25F-RCF-A08	1000 @ 800	560-1600	2A	1.5°	610	150	290	330	455	970	670	46

⊙ 2° mounting available. Consult Cascade.

- ▶ Model shown is with Herringbone contact pads. RXH pads are available upon request.
- ▶ Full height contact pads are available. Consult Cascade for catalog order number.
- ▶ All models come standard with 360° rotation. A 180° Stop Group is also available.

DAMAGE REDUCTION OPTIONS

- 180° mechanical stop group
- Load Cushion™—hoist system accumulator that absorbs shocks, reducing the clamp force required to handle the load
- Tilt Control automatically controls the angle of the mast and pad, aligning the pad with the roll and eliminating expensive product damage
- Light Bar Kit and Multi-Setting Pressure Relief Valve—light bar shows the pressure setting in use when installed with the relief valve

HYDRAULIC FLOW AND PRESSURE

Minimum Flow	Recommended Flow	Maximum Flow (rotate)	Maximum Flow (clamp)	Maximum Pressure
19 LPM	26 LPM	38 LPM	38 LPM	160 bar

HYDRAULIC FUNCTIONS

Model	Hydraulic Functions	Truck Auxiliary Valves Required
Fixed Short Arm	2	2

ROTATOR SPECIFICATIONS

Rotator Speed	Rotator Torque
7.5 RPM @ 38 LPM	4,180 Nm. @ 160 bar