



Rugged construction, great specifications.

APPLICATIONS

To reduce lift truck weight applied to trailer floor in trailer loading applications where 5-6 ton capacity trucks are used; or in applications where the roll weight dictates increased lift truck retained capacity.

MODELS

Fixed Frame/Positioned Short Arm

- Good long-arm profile over a wide range of roll diameters

Swing Frame/Positioned Short Arm

- Improves handling in tight stacking locations such as boxcar breakout. Allows easy lateral positioning
- Arms can be positioned to equal length configuration

FEATURES

- Reduced effective thickness compared to 90F
- Front mounted motor allowing close nesting to lift truck
- High-flow revolving connection
- Clean hydraulic hose and tube routing
- Same rotator speed and torque as 90F
- Same proven cylinder design as 90F
- Full complement of pad options
- Improved visibility through arms



To maximize lift truck capacity, use the 90FX or 100FX Paper Roll Clamp.

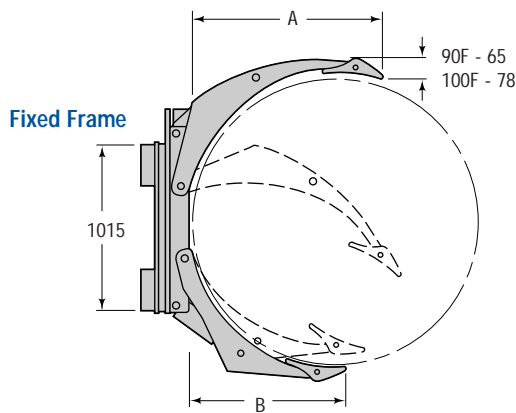

Solid Arm-Split Pad

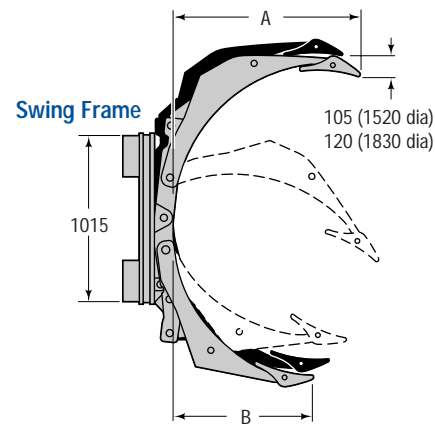
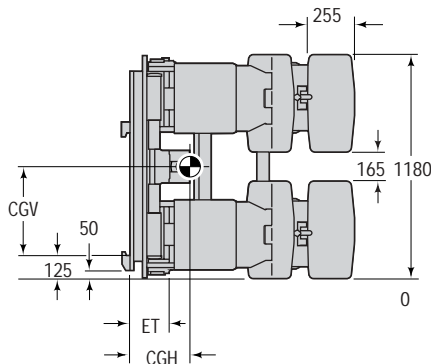

| Capacity kg @ Diameter | Roll Range | Type | Catalog Order No. | Mounting Class ⑤ | Mounting Angle | Weight (Lbs.) | Effective Thickness ET | Horizontal Center of Gravity CGH | Vertical Center of Gravity CGV | Long Arm Length A | Short Arm Length B |
|------------------------|------------|-------------------------------------|-------------------|------------------|----------------|---------------|------------------------|----------------------------------|--------------------------------|-------------------|--------------------|
| 4100 @ 1520 | 250-1520 | Positioned Short Arm | 90FX-RCP-01C ① | IV | 0° | 1340 | 155 | 260 | 460 | 960 | 695 |
| 4100 @ 1520 | 250-1520 | Swing Frame w/ Positioned Short Arm | 90FX-RCS-21C ①②③ | IV | 0° | 1445 | 188 | 275 | 460 | 990 | 675 |
| 4550 @ 1520 | 710-1520④ | Positioned Short Arm | 100FX-RCP-01C ① | IV | 0° | 1380 | 155 | 260 | 610 | 960 | 695 |

- ① Ribbed cast pad standard
- ② Requires 160 bar operating pressure for maximum rated capacity
- ③ Please specify truck voltage and model
- ④ Optional ranges 230-1520 and 530-1520 available
- ⑤ Contact Cascade for Integral Mounting
- ▶ Specify LH or RH input for clamp function

INSTALLATION KIT

| Clamp Type | Catalog Order No. |
|---------------------|-------------------|
| Swing & Fixed Frame | 6003896 |

HYDRAULIC FLOW L/min.

| Minimum | Recommended | Maximum | Maximum Pressure |
|---------|-------------|---------|------------------|
| 38 | 57 | 76 | 160 bar |

HYDRAULIC FUNCTIONS

| Model | Hydraulic Functions | Truck Auxiliary Valves Required |
|----------------------|---------------------|---------------------------------|
| Fixed Short Arm | 2 | 2 |
| Positioned Short Arm | 2 | 2 |
| Swing Frame | 3 | 2 |

- ▶ Swing Frame requires 3 n 2 truck adaption kit.

ROTATOR SPECIFICATIONS

| Rotator Speed | Rotator Torque |
|-------------------|-------------------|
| 3.2 RPM @57L/min. | 11.5 KNm @140 bar |

